



143 Hermitage Road KURRAJONG NSW

4 2 3

Classic country elegance with a luxury finish and quality inclusions. Magnificent "New England" homestead with plantation shutters and extra high ceilings, french doors onto wide verandahs. Formal living area with a marble fireplace feature. Stylish entertaining kitchen with stone benchtops, walk-in pantry, stainless-steel appliances. 4 double bedrooms with garden outlook, brand new ensuite to main. Quality new bathroom. Upstairs loft with built-in cabinetry - ideal home office, library. Superb garden setting with established hedges, circular driveway. Saltwater inground pool and large entertaining gazebo. 3 car auto garaging. 10 grazing acres with a new barn style 3 bay shed. Superb rural location, only minutes from the Village.

Type : House
Land Size : 40200 sqm
View : <https://www.bennettproperty.com.au/sale/nsw/hawkesbury/kurrajong/residential/house/6213098>



Michael Bennett
02 4578 1234

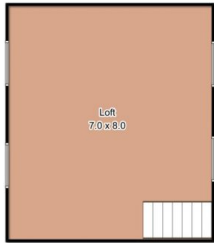

Measurements are approximate only.
Not to scale. For illustrative purposes only.

