



381 Castlereagh Road AGNES BANKS NSW

5 2 3

In a picturesque semi-rural location with delightful views to the Mountains. Set on just over 2 acres with beautifully landscaped gardens, manicured lawns and formal feature fountain on entry. Superb family home with 5 bedrooms, ensuite to main. Large Tasmanian Oak timber kitchen and adjoining meals area. Open plan formal lounge and dining room with slow-combustion fireplace. Large rumpus/games room. Separate granny flat with shower and laundry. Double car garage plus separate workshop. Town water and sewer. Just minutes to Richmond town centre and public transport.

Type : House
Land Size : 8368 sqm
View : <https://www.bennettproperty.com.au/sale/nsw/hawkesbury/agnes-banks/residential/house/6213032>



Michael Bennett
02 4578 1234

Measurements are approximate only.
Not to scale. For illustrative purposes only.



Ground Floor

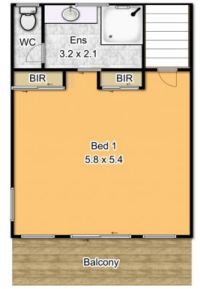

First Floor